

FREEHOLD



BU HOMES

Asking price

£400,000

**CAMBRIA CLOSE,
MAJORS GREEN,
B90 1DR**

- Well Presented Semi-Detached Property
- Re-Fitted Guests WC & Study Area
- Modern Dining Kitchen with Appliances
- Two Further Bedrooms
- Off-Road Parking & Partitioned Garage/Store
- Peaceful Cul-De-Sac Location
- Cosy Lounge with Wood Burning Stove
- Master Bedroom with En-Suite Wash Facilities
- Contemporary Bathroom with Separate Shower
- Attractive Enclosed Rear Garden



A well presented semi-detached family home situated in a peaceful cul-de-sac upon the Southern outskirts of Shirley, Solihull.

Benefiting from large double-glazed windows providing plenty of natural light, the accommodation briefly comprises an enclosed porch, an entrance hall, a re-fitted guests WC, a cosy living room with a wood burning stove, a study area and a modern dining kitchen with integrated appliances; off the first floor landing there is a master bedroom having en-suite wash facilities, two further bedrooms and a contemporary family bathroom with a separate shower cubicle.

Outside, there is a wide driveway at the front affording off-road parking for two vehicles, a partitioned integral garage offering plenty of storage space and an attractive enclosed garden at the rear.

The property is located less than a mile from Shirley Railway Station and approximately two miles from Shirley High Street, on the A34 Stratford Road, which also provides direct access to Birmingham City Centre and the Midlands motorway network.

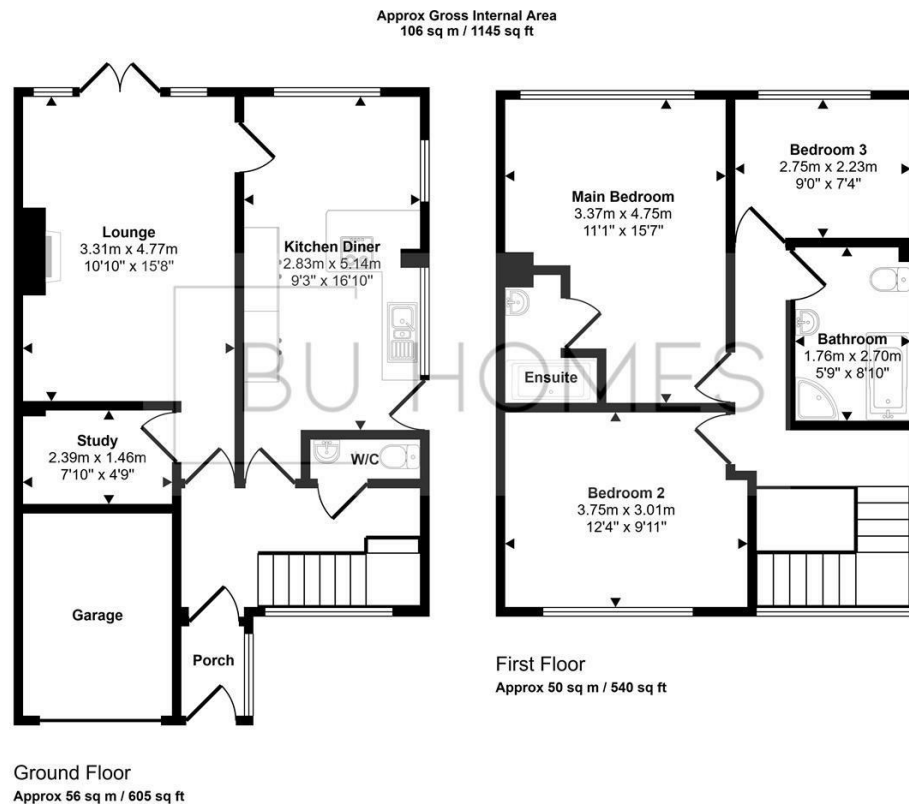

This floorplan is only for illustrative purposes and is not to scale. Measurements of rooms, doors, windows, and any items are approximate and no responsibility is taken for any error, omission or mis-statement. Icons of items such as bathroom suites are representations only and may not look like the real items. Made with Made Snappy 360.

Call us on

0121 7784443

info@buhomes.co.uk

www.buhomes.co.uk

Council Tax Band

D

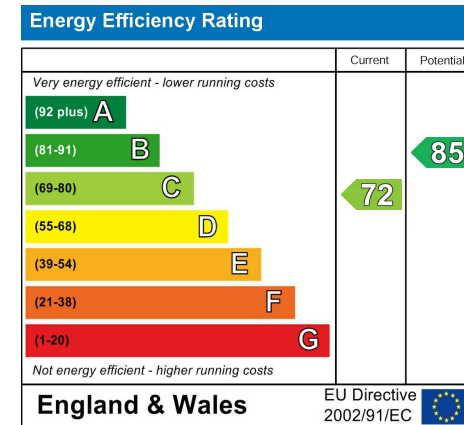

Agents Note: Whilst every care has been taken to prepare these particulars, they are for guidance purposes only. All measurements are approximate and are for general guidance purposes only and whilst every care has been taken to ensure their accuracy, they should not be relied upon and potential buyers are advised to recheck the measurements.

BU HOMES